



No.1 Smithy Court

Pemberton Business Park, Wigan, WN3 6PS

NEXT TO THE NEW M6/M58 LINK ROAD
OPENING 2022 - JUST 3 MINS TO
THE MOTORWAY NETWORK



HIGH QUALITY, MODERN OFFICE ACCOMODATION

FROM 2000 SQ FT UPTO 10000 SQ FT WITH PARKING SPACES

smithycourt.co.uk



SMITHY COURT AT A GLANCE



Premium office space available from 2000 to 10000 sq.ft.



Perfect location, just 3 minutes from the M6 / M58 from 2022



Modern, bright working environment



Great rail links. Just 2 hours 30 minutes to London



Both on-site and nearby off-site car parking available



Close to both Manchester, Preston and Liverpool



AVAILABLE NOW
FROM 2000 SQ FT UPTO 10000 SQFT
OFFICE SUITES WITH PANORAMIC VIEWS

THE BUILDING

Smithy Court is located on Pemberton Business Park, a high quality office development of 86,000 sq ft, set in an attractive landscaped environment.

No.1 Smithy Court is a three storey office building extending to 25,500 sq ft (2,369.03 sq m).

The property is available on a suite by suite basis or a combination of floors equating up to 12,660 sq.ft. The smaller suites are available by way of serviced terms whereby there will be an all inclusive rental to cover rent, rates, utilities, insurance and maintenance.

THE SPECIFICATION

- **Suspended ceiling**
- **Full access raised floor**
- **Air conditioning**
- **Double glazing**
- **Lift to all floors**
- **Designated car parking**
- **Recessed lighting**
- **High quality finishes**
- **Attractive landscaped environment**
- **Flexibility for open plan or cellular layout**
- **Fire alarm**

A LANDMARK OFFICE BUILDING OFFERING
WELL DESIGNED SPACE COMBINED WITH
AN EXCELLENT LOCATION



TYPICAL FLOOR PLAN

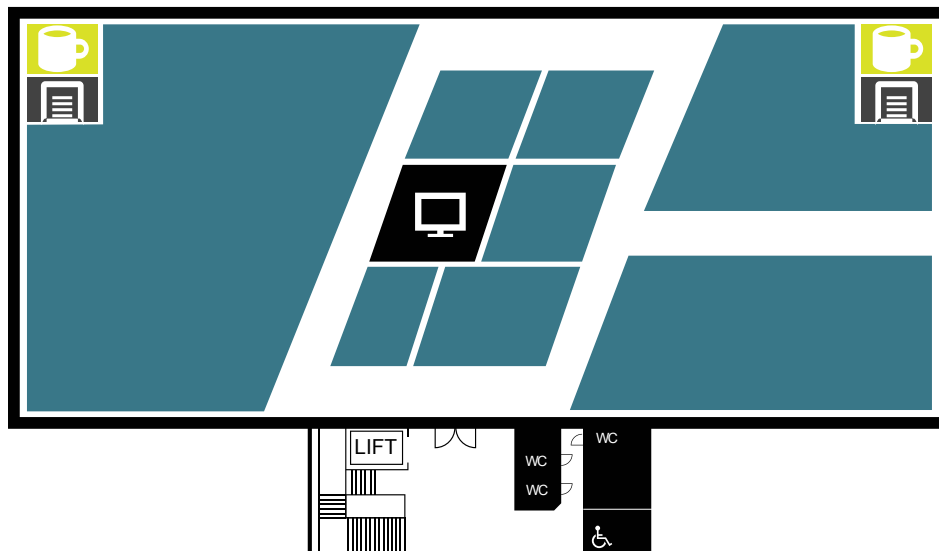

CURRENT AVAILABILITY

**FROM 2000 SQ FT
UPTO 10000 SQ FT
WITH PARKING SPACES**



THE LOCATION

Smithy Court occupies a prominent position on Pemberton Business Park off the A49, Wigan's main arterial route.

The development is 1.5 miles from Wigan town centre and only 1.5 miles from Junction 25 of the M6, providing direct access to the motorway network. Mainline and local routes are available from the 2 Wigan rail stations which are less than 2 miles from Smithy Court. From here London and Glasgow can both be reached in around 2 hours 20 minutes and Manchester within 40 minutes.

Local bus routes are also available nearby.

FUTURE DEVELOPMENTS

Smithy Court is located at the head of the brand new M58 / M6 Link Road. This major road development will significantly reduce the journey time to the motorway network to just 5 minutes. This journey can take over 20 minutes at peak time.

Alongside the new road will be new housing and leisure facilities which will bring the location of Smithy Court into the wider community of Pemberton.

The construction of the new road is due to be completed 2022.

CONTACT

Savills Manchester

savills.co.uk

0161 236 8644



PARKINSON

REAL ESTATE ●●●●

01942 741800

These particulars are set out as a general outline only for the guidance of intending purchasers or lessees, and do not constitute any part of an offer or contract. Details are given without any responsibility, and any intending purchasers, lessees or third parties should not rely on them as statements or representations of fact, but must satisfy themselves by inspection or otherwise as to the correctness of each of them.

April 2016 Designed by Heron Marketing Services.